

Andover III 1257 Sq. Ft. Total Living Area

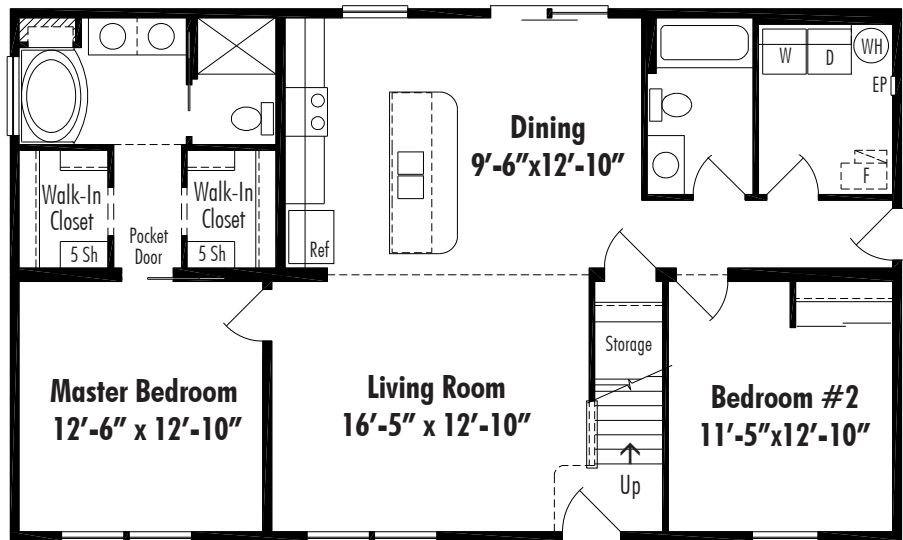

Andover III E Crawl Space 27'-4" x 46', First Floor Living Area 1257 Sq. Ft.

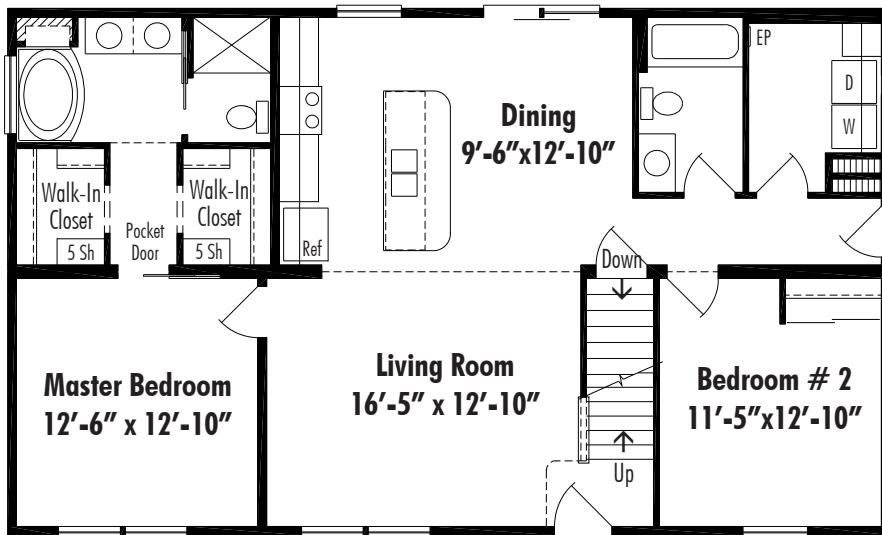

Andover III F Basement 27'-4" x 46', First Floor Living Area 1257 Sq. Ft.

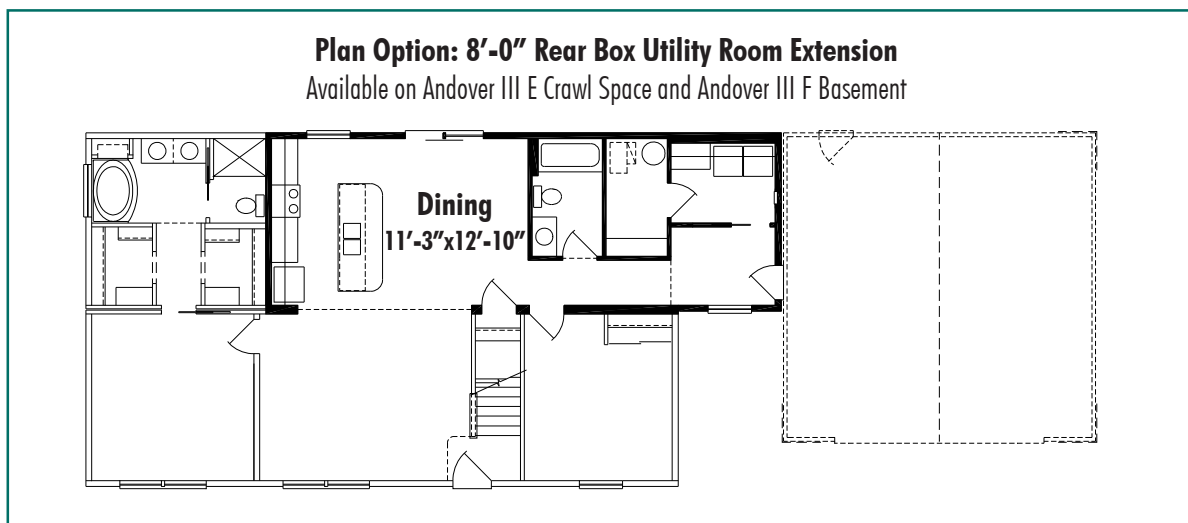

Suggested Layout for Andover III Second Floor

Note: The Second Floor of All Cape Style Homes is Unfinished Space. Shading on the Second Floor Represents Finished Space.

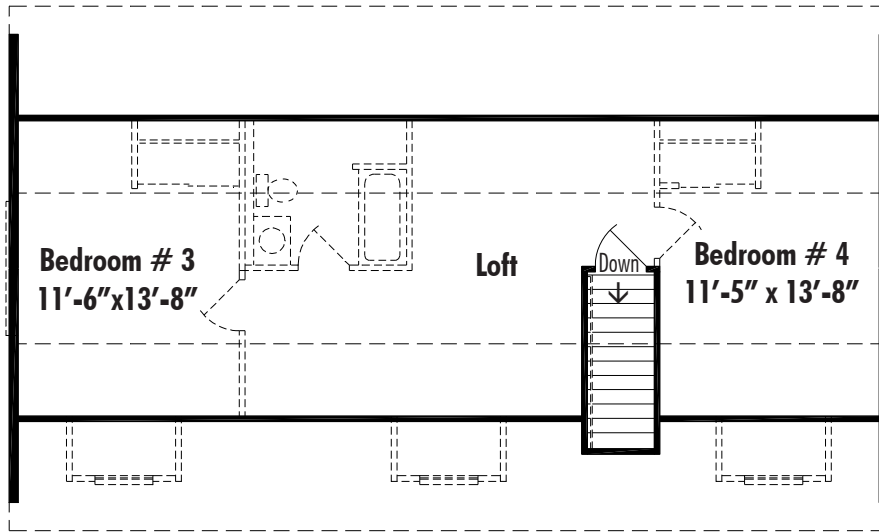

Layout A Front Stairwell Second Floor Living Area 658 Sq. Ft.

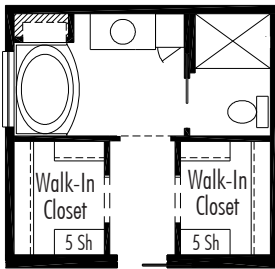
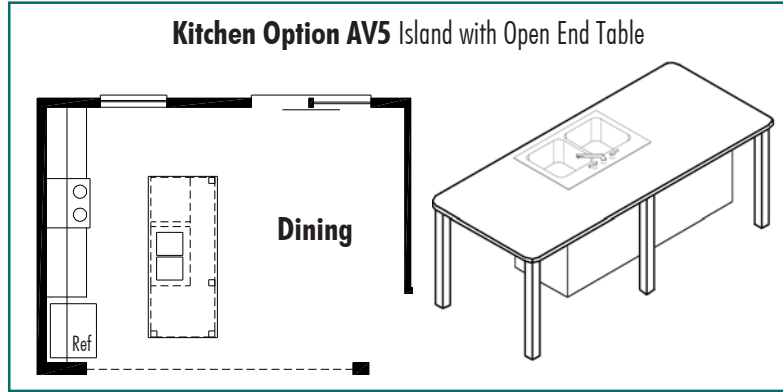

Master Bath Option AVB1
Single Lavatory with Linen Cabinet

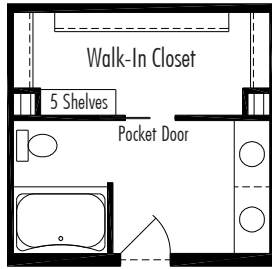

Master Bath Option AVB2
Garden Tub

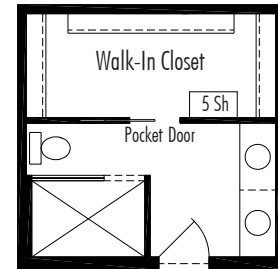

Master Bath Option AVB3
6' Walk-in Tiled Shower with Curb

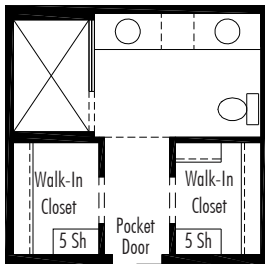

Master Bath Option AVB4
6'-0" Walk-In Tiled Shower with Curb

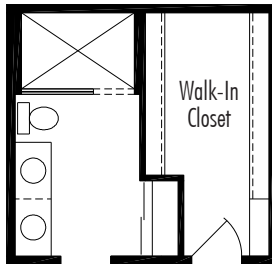

Master Bath Option AVB5
6'-0" Walk-In Tiled Shower with Curb

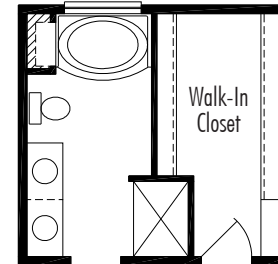

Master Bath Option AVB6
Soaking Tub and Shower